

USER GUIDE | Model 8 in. x 14.75 in.

YOU WILL FIND WITHIN THE PACKAGE

3 x



Magnetic vent covers
(Disk magnets are internal)

6 x



Iron rubber strips (1"x7.5")

GLOSSARY

INTENDED VENT (AKA "REGISTER")



FACEPLATE

DAMPER
LEVER
TYPE



DAMPER
SLIDER
TYPE



DAMPER
WHEEL
TYPE



MAGNETIC VENT COVER

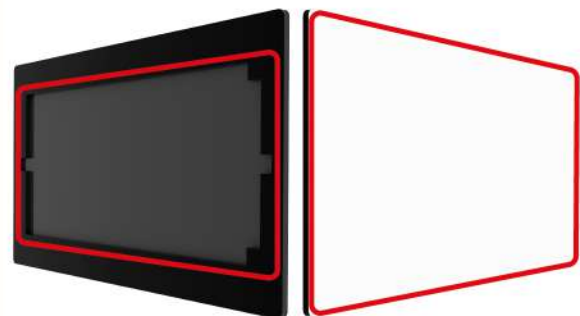

BACKSIDE "POCKET"

FRONT (TOP LAYER)

BEFORE INSTALLATION

1. CHECK THAT YOUR VENT FACEPLATE IS MAGNETIC

Make sure that your vent faceplate is magnetic (made from a magnetic metal). If your vent is made from non-magnetic materials, such as wood, plastic, aluminum, brass etc., our vent covers will not work. If your vent is heavily painted or shows rust, you may want to replace the vent before applying the cover for a better seal.

2. CHECK YOUR VENT SIZE:

Every vent cover we offer is specifically designed to fit a specific vent size. This vent cover is for the following size range:

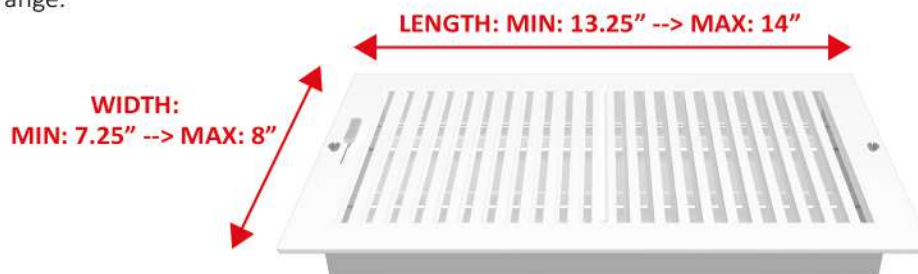

IMPORTANT NOTE: If your vent falls outside of those ranges, please **DO NOT** cut the vent cover.

If you are not sure or need any support, please contact us at info@hmmagnets.com so we can assist!

IF YOU NEED TO EXCHANGE IT TO A DIFFERENT SIZE, A TABLE OF ALL OUR VENT COVER SIZES AND RANGES CAN BE FOUND ON PAGE NUMBER 5.

FLOOR VENTS INSTALLATION

FIRST, PLEASE READ THE 'BEFORE INSTALLATION' AND 'GLOSSARY' SECTIONS ON THE FIRST PAGE

STEP 1: PREPARING YOUR FLOOR VENT FACEPLATE

(1) CLOSE VENT DAMPER - Floor registers usually have a wheel type damper, for closing/opening/changing the air flow direction. Please make sure it is fully closed.

(2) WIPE & CLEAN THE VENT SURFACE - Wipe vent to remove any dust/debris and let it dry.

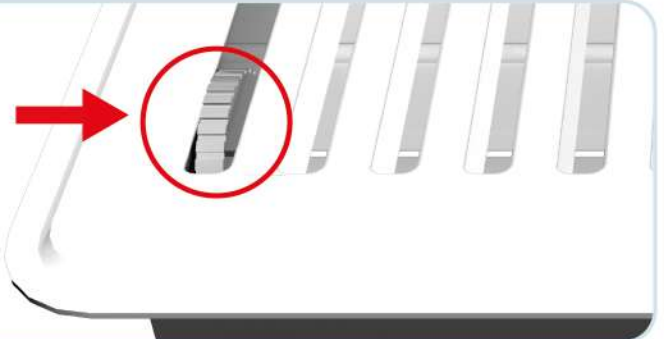

STEP 2: FLOOR VENT COVER APPLICATION:

Note: Floor vents usually don't have any screws. If your floor vent does have screws, please install it according to the sidewall/ceiling guide on the next page.

(1) Unpack the magnetic vent cover and apply it on the intended faceplate. Make sure the cover is covering the vent completely and placed in the exact middle and center of the vent. This will ensure the 6 hidden magnets of the cover are completely and strongly attached to the vent frame.

(2) Once on, it may be necessary to move the cover around until the damper wheel of the vent is inside the vent's pocket. This should result in a complete seal. If there's still a gap and air is escaping, follow step 3.

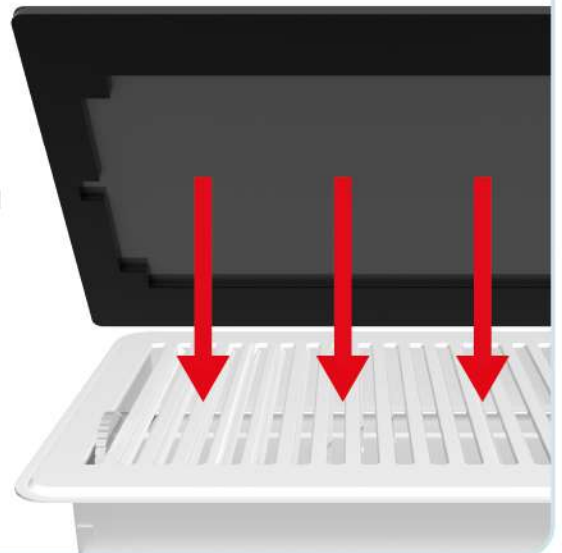

STEP 3 - ADDING IRON STRIPS FOR COMPLETE SEAL (ONLY IF NEEDED)

In some cases, there might be a gap on one or both sides of the vent cover.

(1) If only one side has a gap, try to shift and center the vent cover so that both sides are completely sealed.

(2) If this doesn't help or there are gaps on both sides, you can seal it with the included iron strips.

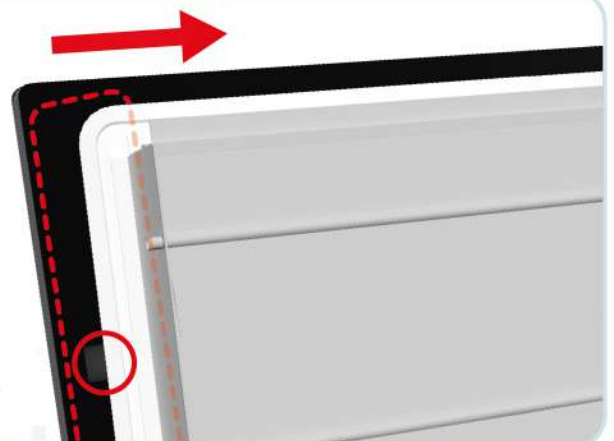

SIDEWALL/CEILING VENTS INSTALLATION

FIRST, PLEASE READ THE 'BEFORE INSTALLATION' AND 'GLOSSARY' SECTIONS ON THE FIRST PAGE

STEP 1: PREPERING YOUR SIDEWALL/CEILING VENT FACEPLATE

(1) CLOSE & FLATTEN VENT DAMPER - Some registers have dampers with a "handle" to close/open/change the air flow direction. It will usually look like a lever or slider. Please make sure they are fully closed and flattened.

(2) WIPE & CLEAN THE VENT SURFACE - Wipe vent to remove any dust/debris and let it dry.

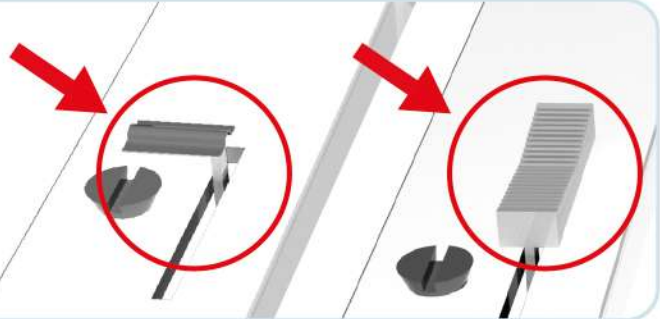

STEP 2: APPLY THE COVER

Unpack the magnetic vent cover and apply it on the intended faceplate using the following instructions:

(1) Identify the cover's backside pocket with the larger cut out (A). Match it to register side with the screw and damper (A).

(2) Identify the cover's backside pocket with the smaller cut out (B). Match it to the register side that only has the screw (B).

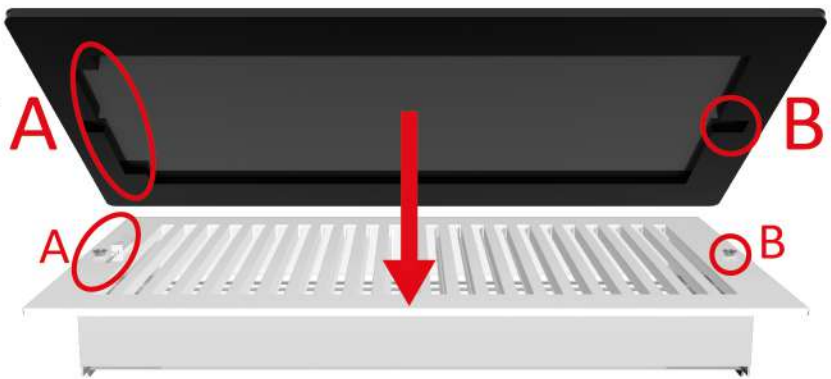

STEP 3 - FINDING THE CORRECT POSITION OF THE COVER

(1) Please don't worry if the damper is still lifting the entire vent cover and breaking the seal. Be patient, this will be solved completely in the following steps.

(2) Start shifting the "A" side of the cover, so that the screw head on that side is as close as possible to the edge of the cut out.

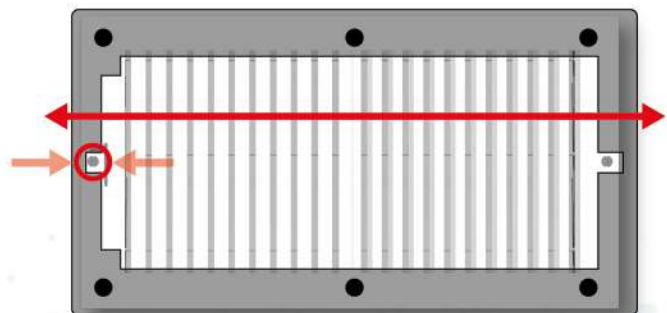
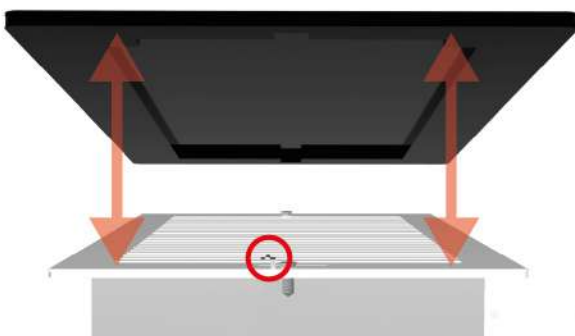

STEP 4: EXTRACTING THE VENT DAMPER (ONLY IF NEEDED)

In some cases, the damper is not flat enough and is lifting the entire vent cover and breaking the seal. If this is the case, you may need to make a cut at the top of the vent cover so the damper is exposed. Do it as follows:

OPTION (A): "LEVER" TYPE DAMPER

Step (1) - Make sure the lever is fully closed. Mark on top of the cover the exact location of the lever's base (red mark). Do not mark the actual position of the handle (black mark).

Step (2) - Take the cover off and make a small slit. A full cutout is not necessary.

Step (3) - Slip lever through the slit and shift the cover back to the correct position as it was before.

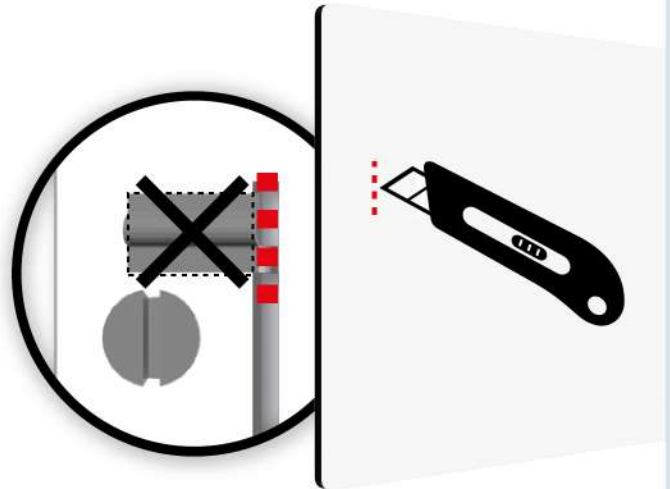

OPTION (B): "SLIDER" TYPE DAMPER

Step (1) - Make sure the slider is fully closed. Mark on top of the cover its exact location (Use the bulge produced by the slider).

Step (2) - Take the cover off and carefully make the cutout.

Step (3) - Place the vent cover back as it was before.

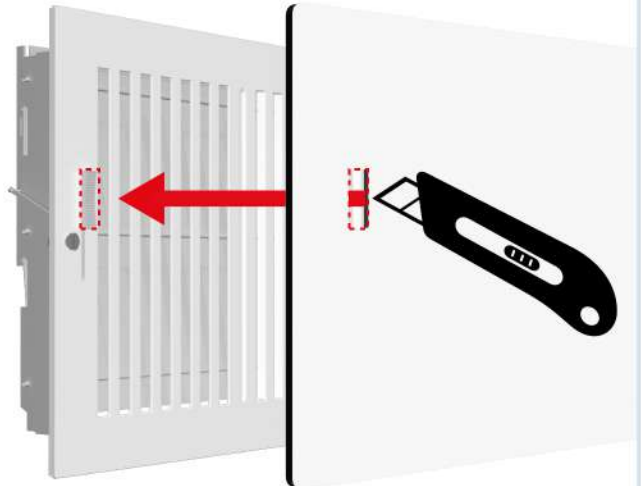

STEP 5 - ADDING IRON STRIPS FOR COMPLETE SEAL (ONLY IF NEEDED)

In some cases, there might be a small gap between the vent cover pocket and your vent. For a complete seal, insert the included iron strip in the gaps, as follows:

OPTION 1 - ON THE SCREW

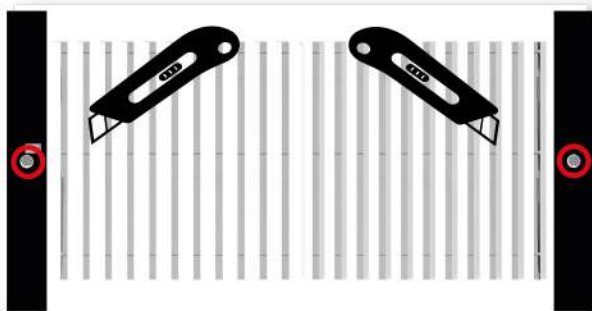

OPTION 2 - NEXT TO THE SCREW



NEED A DIFFERENT SIZE?

TABLE OF ALL OUR VENT COVER SIZES AND RANGES

THIS MODEL IS MARKED IN RED

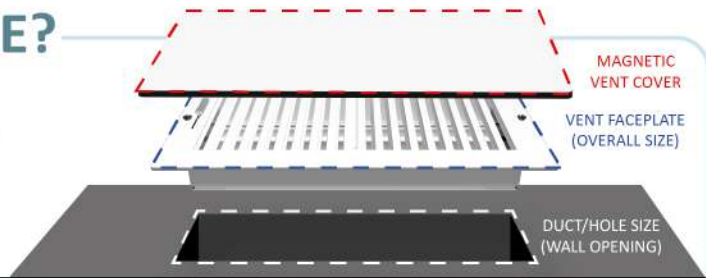

YOUR VENT FACEPLATE OVERALL SIZE (NOT DUCT SIZE)		MATCHING VENT COVER MODEL (Can be found at Amazon.com/hmmagnets)	VENT DUCT HOLE SIZE (WALL OPENING)
WIDTH RANGE	LENGTH RANGE		
FROM 3.25" TO 4" WIDE	FROM 11.25" TO 12" LONG	4" x 12.5" (3 PACK) - White OR Black	2" x 10"
	FROM 13.25" TO 14" LONG	4" x 14.5" (3 PACK) - White OR Black	2" x 12"
	FROM 15.25" TO 16" LONG	4" x 16.5" (3 PACK) - White OR Black	2" x 14"
FROM 5.25" TO 6" WIDE	FROM 9.25" TO 10" LONG	6" x 10.75" (3 PACK) - White OR Black	4" x 8"
	FROM 11.25" TO 12" LONG	6" x 12.75" (3 PACK) - White OR Black	4" x 10"
	FROM 13.25" TO 14" LONG	6" x 14.75" (3 PACK) - White OR Black	4" x 12"
	FROM 15.25" TO 16" LONG	6" x 16.75" (3 PACK) - White OR Black	4" x 14"
FROM 7.25" TO 8" WIDE	FROM 7.25" TO 8" LONG	8.75" x 8.75" (2 PACK) - White	6" x 6"
	FROM 9.25" TO 10" LONG	8" x 10.75" (3 PACK) - White	6" x 8"
	FROM 11.25" TO 12" LONG	8" x 12.75" (3 PACK) - White OR Black	6" x 10"
	FROM 13.25" TO 14" LONG	8" x 14.75" (3 PACK) - White OR Black	6" x 12"
	FROM 15.25" TO 16" LONG	8" x 16.75" (2 PACK) - White	6" x 14"
FROM 9.25" TO 10" WIDE	FROM 9.25" TO 10" LONG	10.75" x 10.75" (2 PACK) - White	8" x 8"
	FROM 11.25" TO 12" LONG	10" x 12.75" (2 PACK) - White	8" x 10"
	FROM 13.25" TO 14" LONG	10" x 14.75" (2 PACK) - White	8" x 12"
	FROM 15.25" TO 16" LONG	10" x 16.75" (2 PACK) - White	8" x 14"
FROM 11.25" TO 12" WIDE	FROM 11.25" TO 12" LONG	12.75" x 12.75" (2 PACK) - White	10" x 10"

RECEIVED A USED PRODUCT? MISSING PARTS?

If you have a reason to believe you have received a used product, please contact us. Our stock of units is fully handled by Amazon, and unfortunately, sometimes they mistakenly send customers used units (which were previously returned or opened). Because we don't have any control over their warehouse internal process, please contact us for support so we can assist.

CONTACT DETAILS

Christa here! First, I wanted to personally thank you for your purchase. We are a small US family business, and every new customer means a lot to us.

For any issues or questions, please don't hesitate to contact us at info@hmmagnets.com so we can assist you :)

We try our best to reply within 24 hours.

Best,
Christa
HMmagnets founder